

Service Manual

REPAIR & ADJUSTMENTS

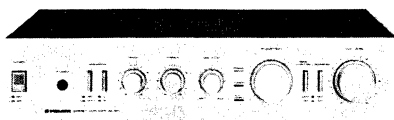

**ORDER NO.
ART-646-0**

STEREO AMPLIFIER

SA-420

MODEL SA-420 COMES IN FIVE VERSIONS DISTINGUISHED AS FOLLOWS:

Type	Voltage	Remarks
KU	120V only	U.S.A. model
S	110V, 120V, 220V and 240V (Switchable)	General export model
YP	240V only	Australia model
HE	220V and 240V (Switchable)	Europe model
HB	220V and 240V (Switchable)	United Kingdom model

- This service manual is applicable to the KU type (pp. 1 – 17), YP and S types (pp. 19 – 27). When repairing the HE, HB types, please see the additional service manual (ART-647). *+ 1430*
- For the circuit description, please refer to the supplement of model SA-720 service manual (ART-765).
- Ce manuel d'instruction se réfère au mode de réglage, en français. *+ 1312*
- Este manual de servicio trata del método de ajuste escrito en español.

CONTENTS

1. SPECIFICATIONS	2	8. ELECTRICAL PARTS LIST	13
2. FRONT PANEL FACILITIES	3	9. PACKING	14
3. BLOCK DIAGRAM	4	10. ADJUSTMENT	15
4. PARTS LOCATION	5	RÉGLAGE	16
5. EXPLODED VIEW	6	AJUSTE	17
6. P.C. BOARDS CONNECTION DIAGRAM	8	ADDITIONAL SERVICE MANUAL FOR YP, AND S TYPES	19
7. SCHEMATIC DIAGRAM	11		

1. SPECIFICATIONS

Amplifier Section

Continuous power output of 21 watts* per channel, min., at 8 ohms from 30 Hertz to 20,000 Hertz with no more than 0.1% total harmonic distortion.

Total Harmonic Distortion (30 Hertz to 20,000 Hertz, 8 ohms, from AUX) 10 watts per channel power output No more than 0.05%
Intermodulation Distortion (50 Hertz: 7,000 Hertz = 4 : 1 8 ohms, from AUX) continuous rated power output 10 watts per channel power output	No more than 0.2%
 No more than 0.08%
Damping Factor (20 Hertz to 20,000 Hertz, 8 ohms)	30
Input (Sensitivity/Impedance)	
PHONO	2.5mV/50 kilohms
TUNER	150mV/50 kilohms
AUX	150mV/50 kilohms
TAPE PLAY/ADAPTOR	150mV/50 kilohms
Phono Overload Level (T.H.D. 0.1%, 1,000Hz)	
PHONO	120mV
Output (Level)	
TAPE REC/ADAPTOR	150mV
Speaker	A, B, OFF
Frequency Response	
PHONO (RIAA Equalization) 30Hz to 15,000Hz±0.5dB
TUNER, AUX, TAPE PLAY/ADAPTOR 10Hz to 60,000Hz±3dB
Tone Control	
BASS	±9.5dB (100Hz)
TREBLE	±9.5dB (10,000Hz)
Loudness Contour (Volume control set at -40dB position)	
.....	+8dB (100Hz), +0dB (10,000Hz)
Hum and Noise (IHF, short-circuited, A network)	
PHONO	72dB
TUNER, AUX, TAPE PLAY/ADAPTOR	97dB

Miscellaneous

Power Requirements	AC 120V, 60Hz
Power Consumption	60W (UL)
Dimensions	420(W) x 94(H) x 267(D) mm 16-9/16(W) x 3-11/16(H) x 10-1/2(D) in
Weight (without package)	4.6 kg (10 lb 2 oz)

NOTE:

Specifications and the design subject to possible modifications without notice due to improvements.

** Measured pursuant to the Federal Trade Commission's Trade Regulation rule on Power Output Claims for Amplifiers.*

2. FRONT PANEL FACILITIES

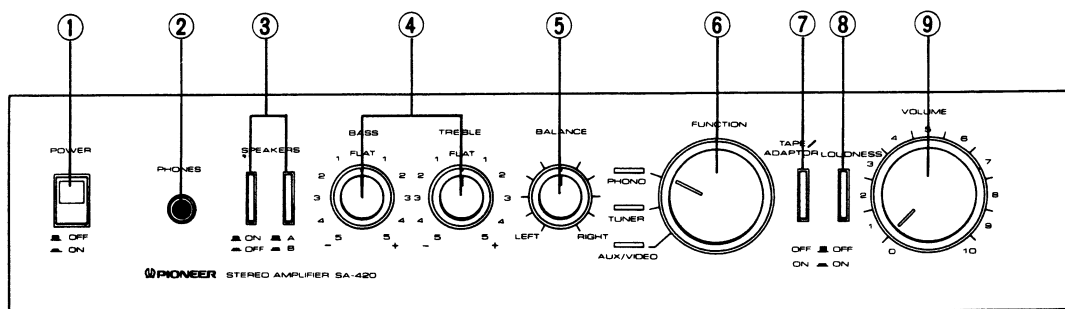

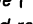
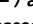
- The () and () for the pushbutton switches on the panel indicate the depressed and released position, respectively.

① POWER SWITCH



Depress this switch to turn on or off power. When this switch is depressed, power is supplied. When this switch is released, power is turned OFF.

② PHONES JACK

Plug headphones into this jack for private listening. Set the SPEAKERS selection switch to OFF.

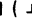
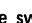
③ SPEAKERS SELECTOR

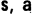
These two switches are used to switch the output signals of the stereo amplifier's speaker terminals. The switch on the left switches the output signals on and off. When listening to the sound through the speakers, set this switch to the released position ON (). No sound will be heard through the speakers when this switch is set to the depressed position OFF ().

The switch on the right selects the A or B sets of speaker terminals. Set to the released position A () when listening to the sound from the speaker systems connected to the A speaker terminals, and to the depressed position B () when listening from the speaker systems connected to the B speaker terminals.

④ BASS AND TREBLE CONTROLS

Use these controls to adjust the tone. The right one controls treble and the left one controls bass.

FLAT is the neutral position. Turning knob clockwise accentuates the bass or treble, and turning knob counter-clockwise attenuates the bass or treble.

⑤ BALANCE CONTROL

This control should normally be set to center position. When the output from the left and right speakers or headphones is not the same, adjust by turning the control clockwise or counterclockwise.

⑥ FUNCTION SELECTOR

Use this selector to select the program source. When set, the function indicator corresponding to the position of the function selector will light up.

⑦ TAPE/ADAPTOR SWITCH

Depress this switch to ON when using a tape deck or a graphic equalizer (or any equipment) connected to the TAPE/ADAPTOR terminal.

⑧ LOUDNESS SWITCH

Depress this switch to ON when listening at low volume. Bass will be emphasized to compensate for human listening characteristics and provide natural listening curve.

⑨ VOLUME CONTROL

Turn this control to adjust the output level to the speakers and the headphones. Output is minimum at 0 and increases as the control is turned clockwise.

3. BLOCK DIAGRAM

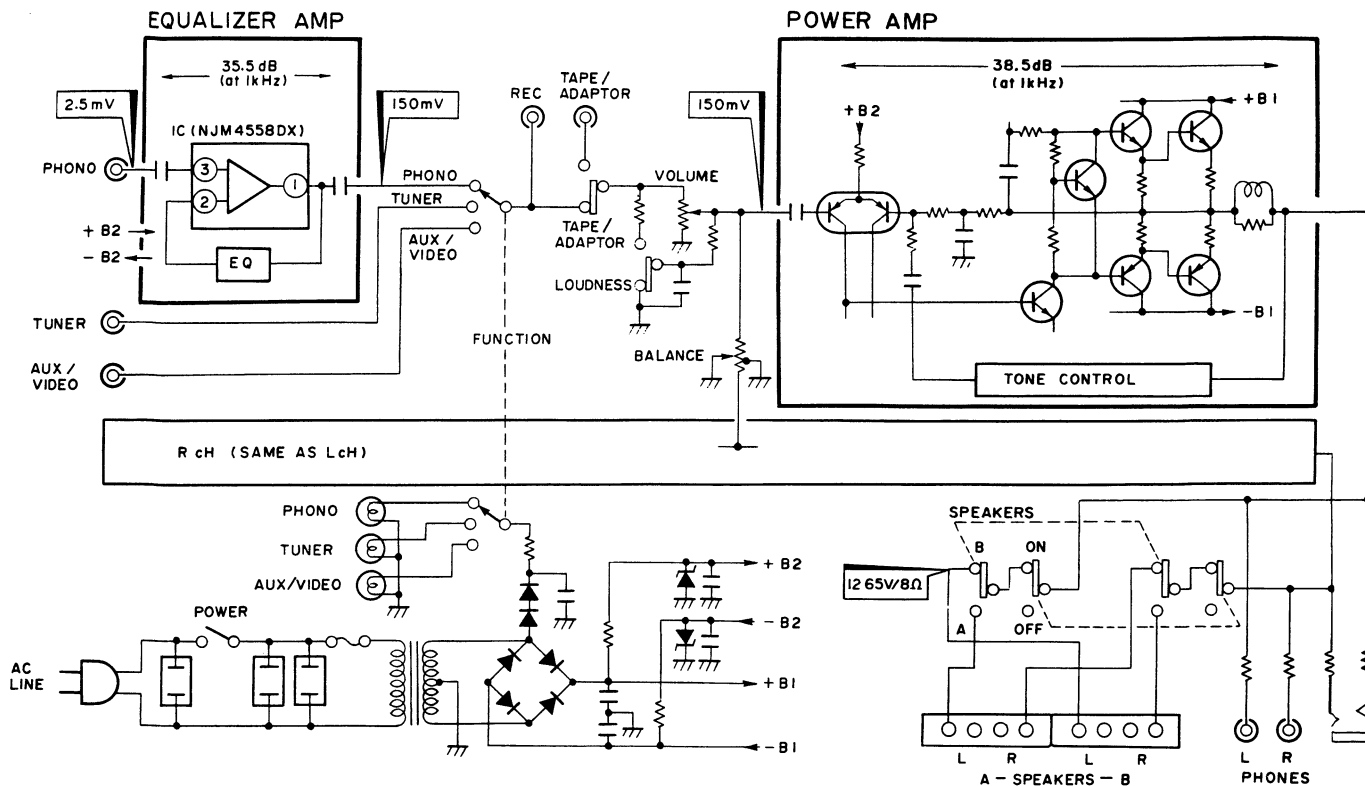

Top View

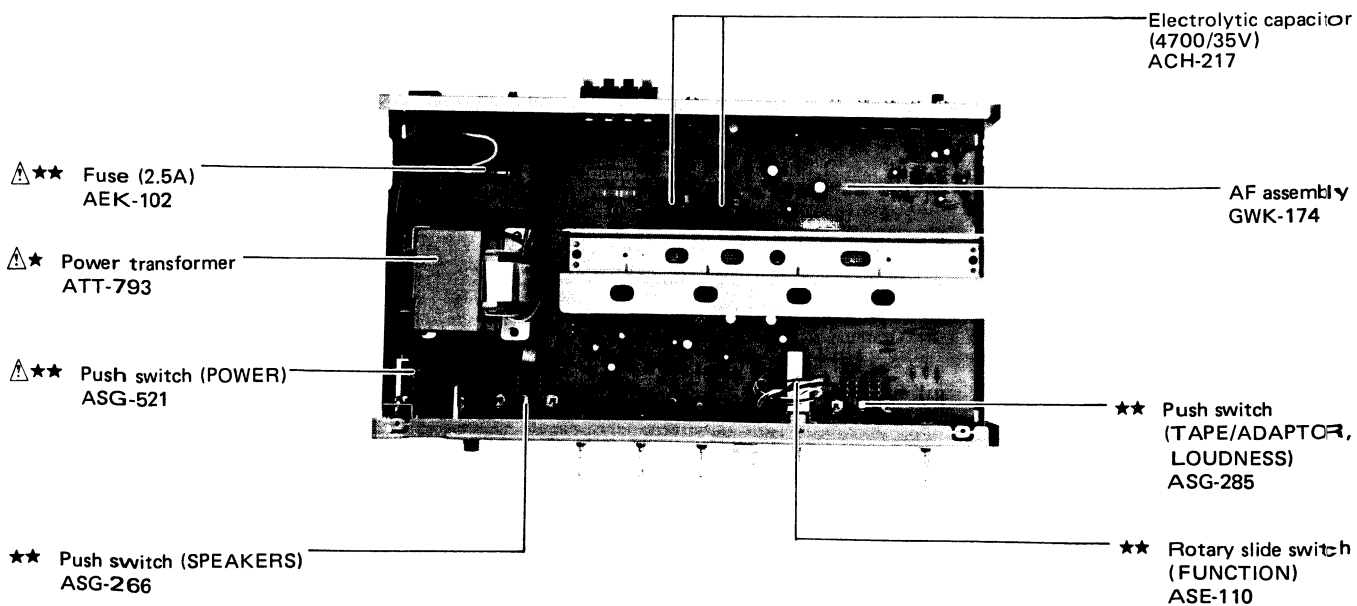

4. PARTS LOCATION

- The \triangle mark found on some component parts indicates the importance of the safety factor of the part. Therefore, when replacing, be sure to use parts of identical designation.
- For your Parts Stock Control, the fast moving items are indicated with the marks **★★** and **★**.
★★ GENERALLY MOVES FASTER THAN ★.
This classification shall be adjusted by each distributor because it depends on model number, temperature, humidity, etc.

Front Panel View

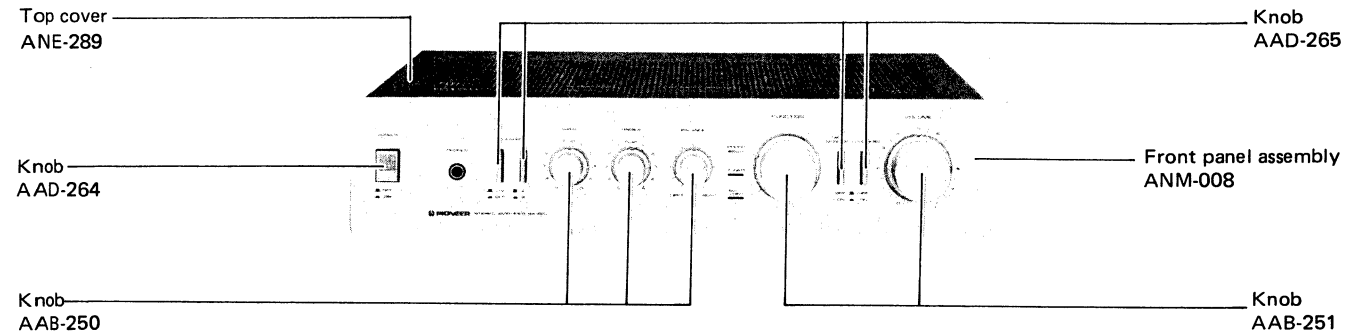

Front View with Panel Removed

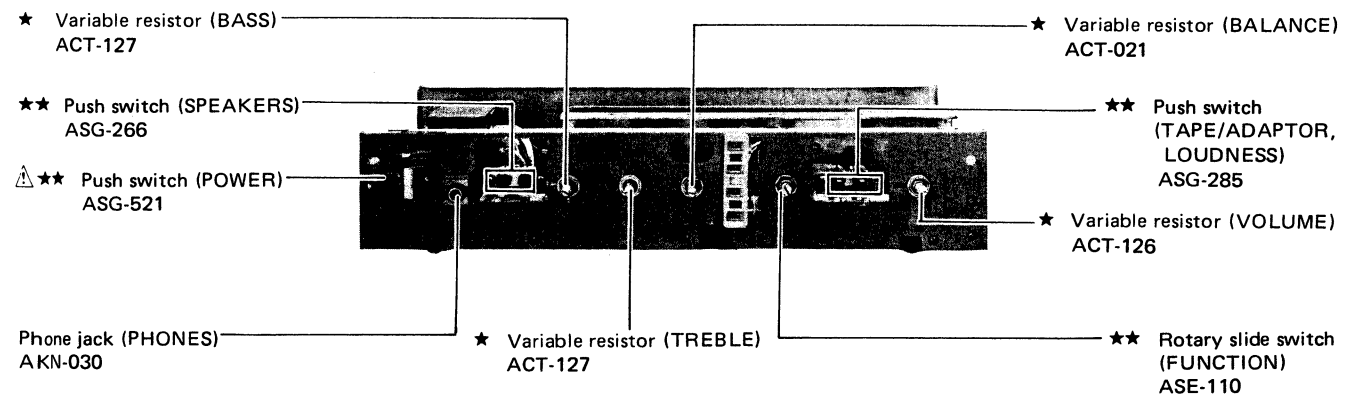

Rear Panel View

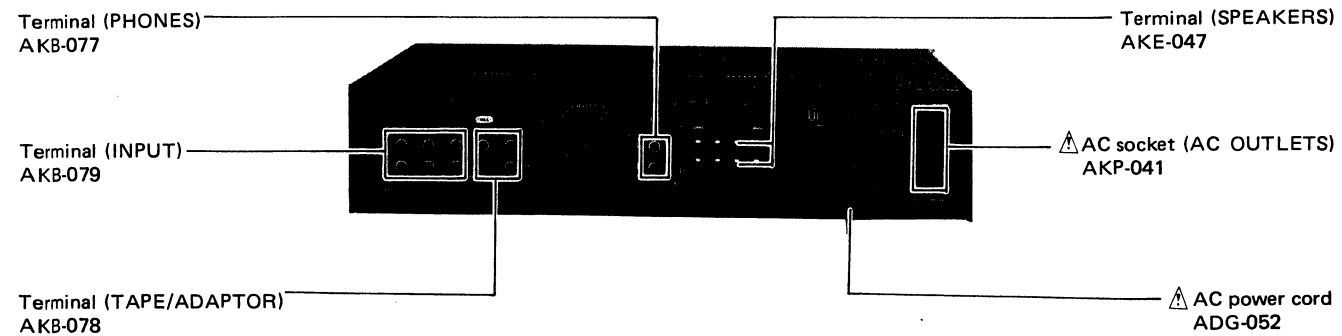

5. EXPLODED VIEW

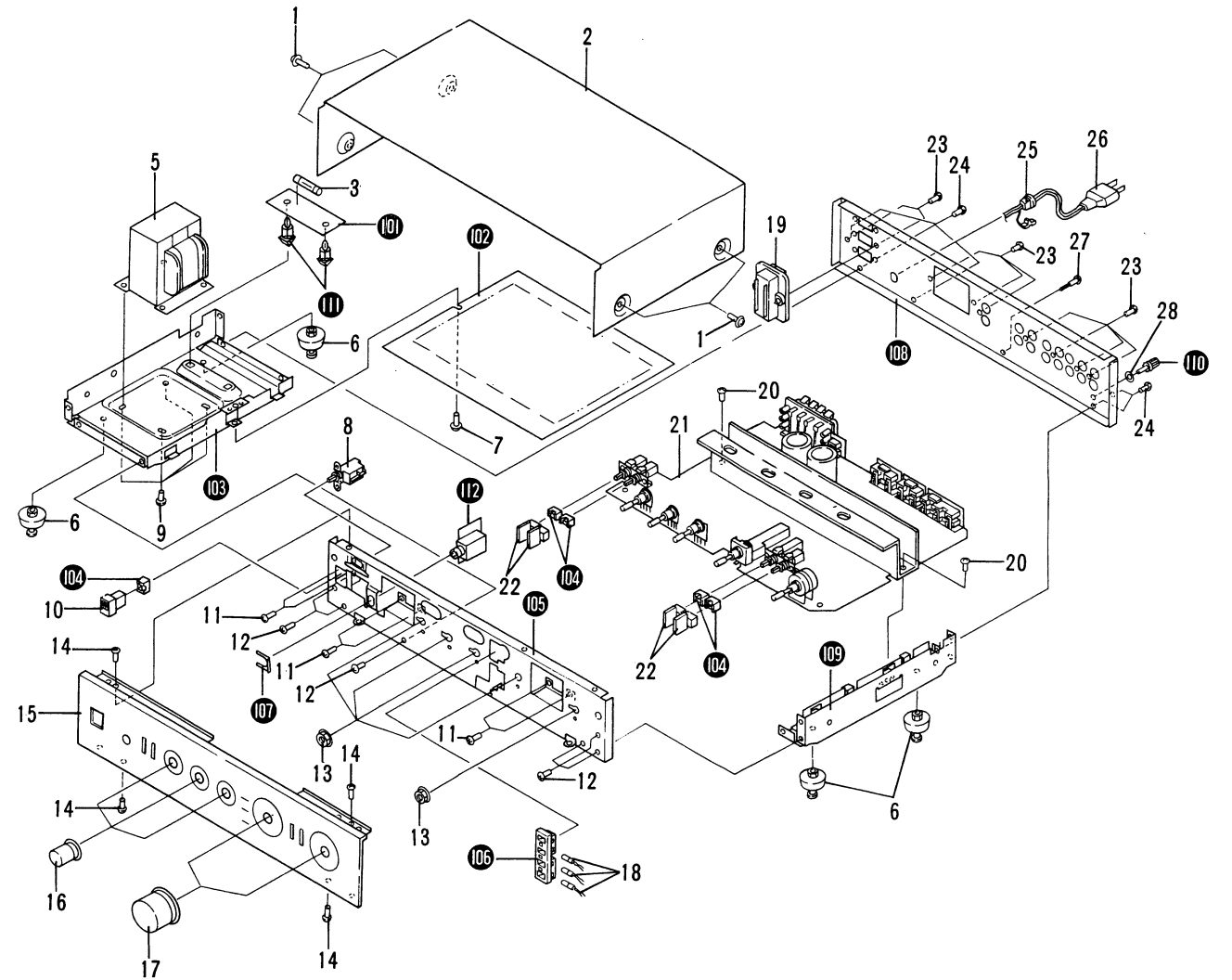

5. EXPLODED VIEW

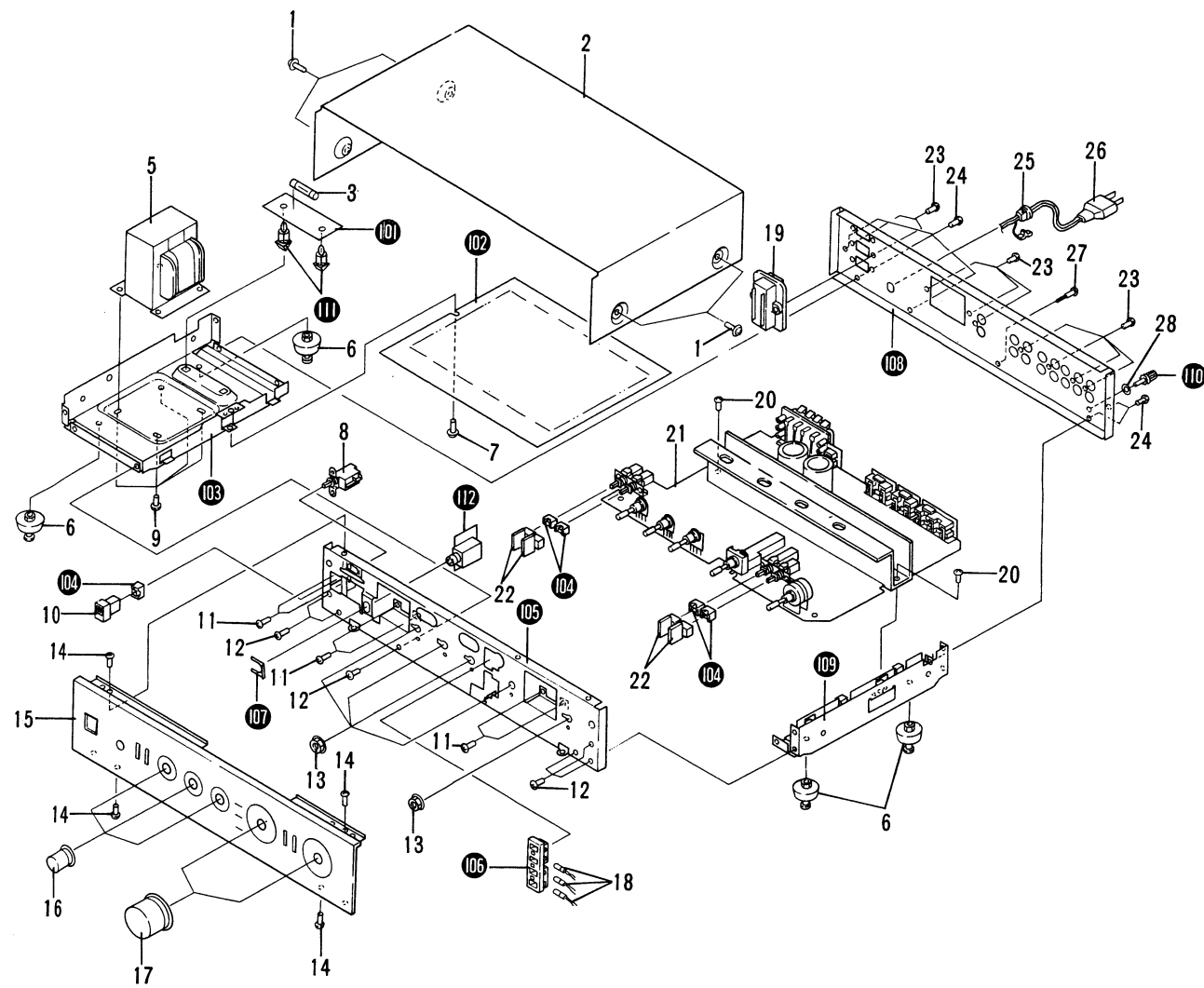

NOTES:

- Parts without part number cannot be supplied.
- The Δ mark found on some component parts indicates the importance of the safety factor of the part. Therefore, when replacing, be sure to use parts of identical designation.
- For your Parts Stock Control, the fast moving items are indicated with the marks **★★** and **★**.
★★ GENERALLY MOVES FASTER THAN ★.
 This classification shall be adjusted by each distributor because it depends on model number, temperature, humidity, etc.

Parts List of Exploded View

Mark	No.	Part No.	Description	Mark	No.	Part No.	Description
	1.	FBT40P080FZK	Screw 4x8		21.	GWK-174	AF assembly
Δ ★★	2.	ANE-289	Top cover		22.	AAD-265	Knob (SPEAKERS, LOUDNESS, TAPE/ADAPTOR)
	3.	AEK-102	Fuse (2.5A)		23.	MTZ30P100FZK	Screw 3x10
Δ ★	4.			24.	VCT30P060FZK	Screw 3x6
	5.	ATT-793	Power transformer		25.	AEC-327	Strain relief
	6.	AEC-672	Foot assembly	Δ	26.	ADG-052	AC power cord
Δ ★★	7.	ABA-246	Screw 3x12		27.	ABA-176	Screw
	8.	ASG-521	Push switch (POWER)		28.	WA35F100N080	Washer
	9.	VXZ40P080FMC	Screw 4x8		101.		Fuse assembly
	10.	AAD-264	Knob (POWER)		102.		Bottom plate
	11.	PMZ30P060FMC	Screw 3x6		103.		Frame
	12.	VCZ30P060FMC	Screw 3x6		104.		Flexible joint
	13.	ABN-024	Nut M9		105.		Panel stay
	14.	VBZ30P080FMC	Screw 3x8		106.		Lamp holder
	15.	ANM-008	Front panel assembly		107.		Mounting plate
	16.	AAB-250	Knob (BASS, TREBLE, BALANCE)		108.		Rear panel
	17.	AAB-251	Knob (VOLUME, FUNCTION)		109.		Right frame
★★	18.	AEL-075	Lamp (Wire term. 8V/50mA)		110.		Terminal (GND)
Δ	19.	AKP-041	AC socket (AC OUTLETS)		111.		P.C. Board holder
	20.	BBT30P080FZK	Screw 3x8		112.		Headphones jack assembly

AF Ass'y(GWK-174)

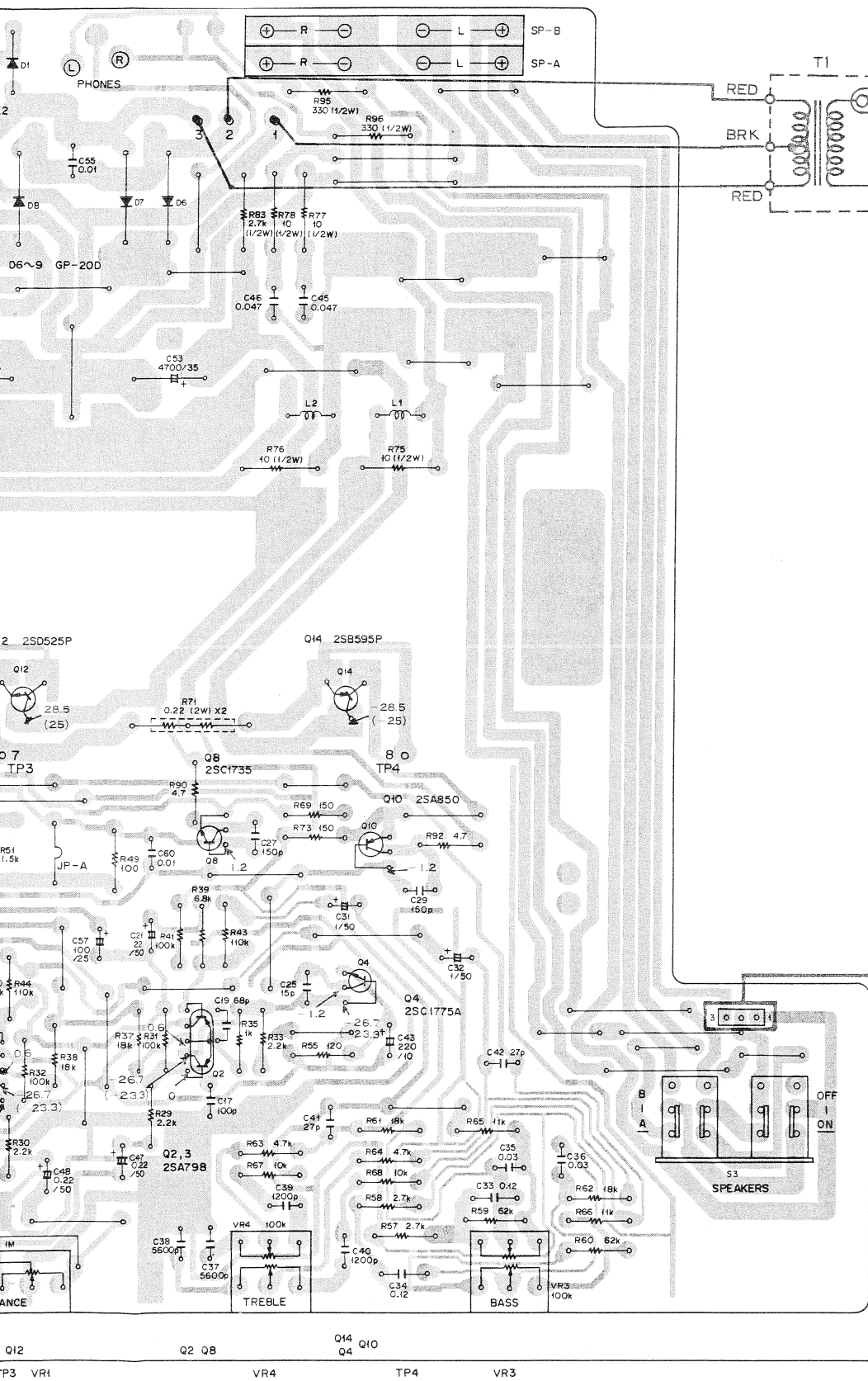

External Appearance of Transistors and ICs

2SA798

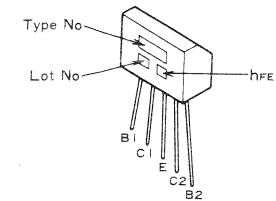

A

2SA850
2SC1735

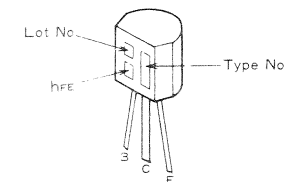

B

2SB595P
2SD525P

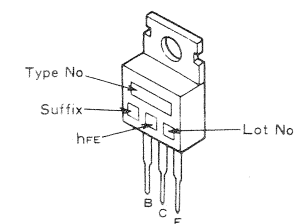

C

2SC1775A

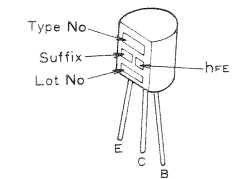

2SC945A

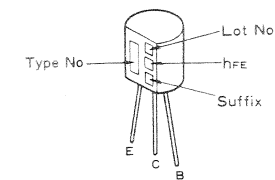

2SC1815

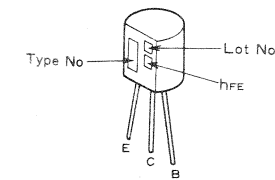

D

7. SCHEMATIC DIAGRAM

NOTE:
The indicated semiconductors are representative ones only. Other alternative semiconductors may be used and are listed in the parts list.

AF Ass'y GWK-174

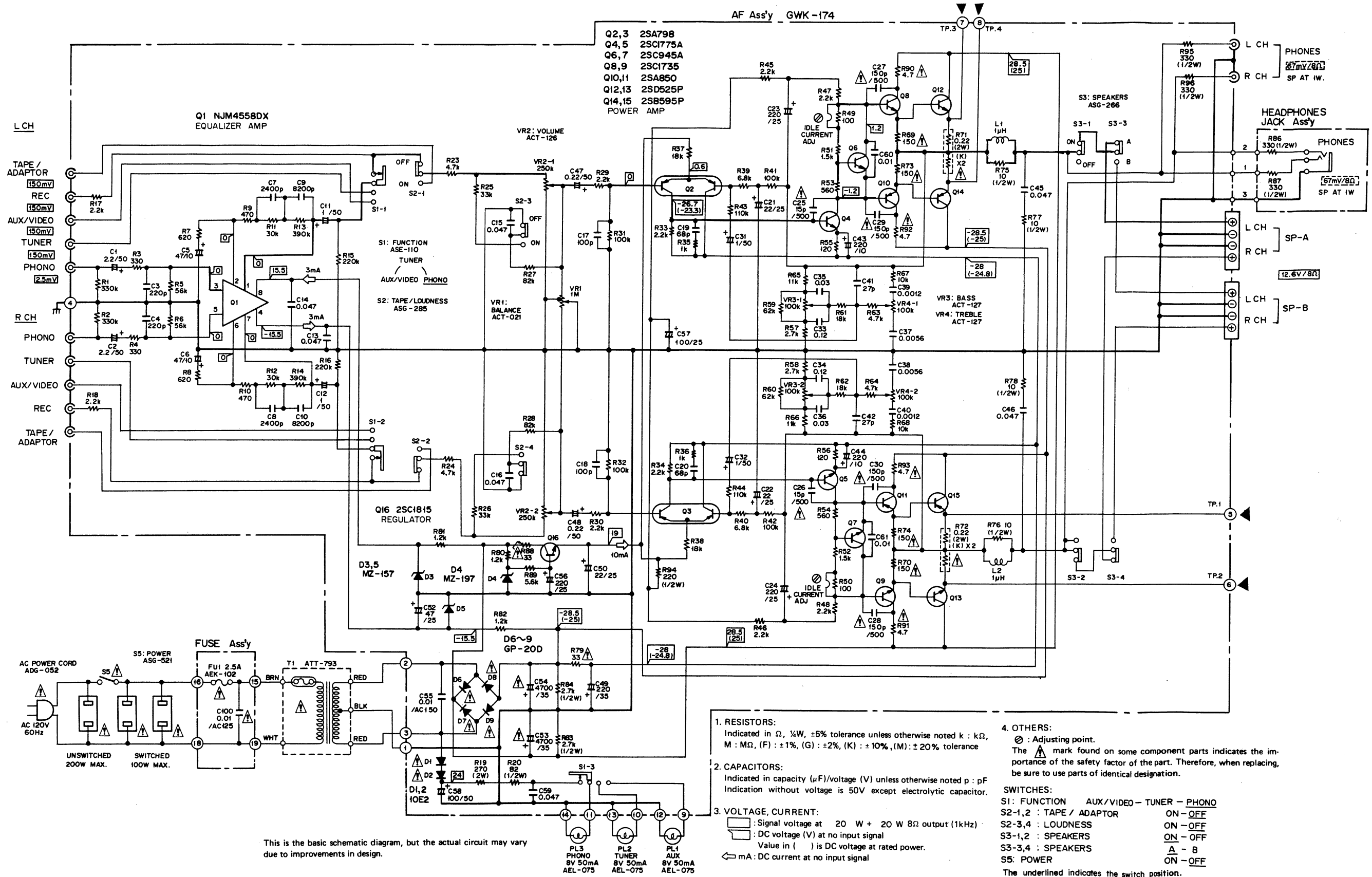

This is the basic schematic diagram, but the actual circuit may vary due to improvements in design.

- RESISTORS:**
Indicated in Ω, ¼W, ±5% tolerance unless otherwise noted k : kΩ, M : MΩ, (F) : ±1%, (G) : ±2%, (K) : ±10%, (M) : ±20% tolerance
- CAPACITORS:**
Indicated in capacity (μF)/voltage (V) unless otherwise noted p : pF
Indication without voltage is 50V except electrolytic capacitor.
- VOLTAGE, CURRENT:**
⊖ : Signal voltage at 20 W + 20 W 8Ω output (1kHz)
⊖ : DC voltage (V) at no input signal
Value in () is DC voltage at rated power.
← mA : DC current at no input signal

- OTHERS:**
⊗ : Adjusting point.
The Δ mark found on some component parts indicates the importance of the safety factor of the part. Therefore, when replacing, be sure to use parts of identical designation.
- SWITCHES:**
S1 : FUNCTION AUX/VIDEO - TUNER - PHONO
S2-1,2 : TAPE / ADAPTOR ON - OFF
S2-3,4 : LOUDNESS ON - OFF
S3-1,2 : SPEAKERS ON - OFF
S3-3,4 : SPEAKERS A - B
S5 : POWER ON - OFF
The underlined indicates the switch position.

8. ELECTRICAL PARTS LIST

NOTES:

- When ordering resistors, first convert resistance values into code form as shown in the following examples.

Ex. 1 When there are 2 effective digits (any digit apart from 0), such as 560 ohm and 47k ohm (tolerance is shown by J = 5%, and K = 10%).

560Ω 56 x 10¹ 561 RD¼PS 561J

47kΩ 47 x 10³ 473 RD¼PS 473J

0.5Ω 0R5 RN2H 0R5K

1Ω 010 RS1P 010K

Ex. 2 When there are 3 effective digits (such as in high precision metal film resistors).

5.62kΩ 562 x 100 5621 RN¼SR 5621F

- The Δ mark found on some component parts indicates the importance of the safety factor of the part. Therefore, when replacing, be sure to use parts of identical designation.

- For your Parts Stock Control, the fast moving items are indicated with the marks **★★** and **★**.

★★ GENERALLY MOVES FASTER THAN ★.

This classification shall be adjusted by each distributor because it depends on model number, temperature, humidity, etc.

Miscellaneous Parts

Mark	Part No.	Symbol & Description	Mark	Part No.	Symbol & Description
Δ ★	ATT-793	T1 Power transformer	Δ	CCDSL 150K 500	C25, C26
Δ ★★	AEK-102	FU1 Fuse (2.5A)	Δ	CCDSL 151K 500	C27-C30
Δ ★★	AEL-075	PL1-PL3 Lamp (Wire term. 8V/50mA)		CCDSL 270J 50	C41, C42
Δ ★★	ASG-521	S1 Push switch (POWER)		CCDSL 680J 50	C19, C20
Δ	AKP-041	AC socket (AC OUTLETS)		CCDSL 101J 50	C17, C18
Δ	ADG-052	AC power cord			
	GWK-174	AF assembly		CCDSL 221J 50	C3, C4
				CKDYF 473Z 50	C13-C16, C45, C46, C59
				CKDYF 103Z 50	C60, C61

AF Assembly (GWK-174)

CAPACITORS

Mark	Part No.	Symbol & Description
	CEANL 2R2M 50	C1, C2
Δ	ACH-217	C53, C54 Electrolytic (4700/35V)
	ACG-019	C55 Ceramic (0.01/AC150V)
	CEANL R22M 50	C47, C48
	CEANL 010M 50	C31, C32
	CEA 010M 50L	C11, C12
	CEA 220M 25L	C21, C22, C50
	CEA 470M 10L	C5, C6
	CEA 101M 25L	C57
	CEA 101M 50L	C58
	CEA 221M 10L	C43, C44
	CEA 470M 25L	C52
	CEA 221M 25L	C23, C24, C56
	CEA 221M 35L	C49
	CQMA 122K 50	C39, C40
	CQMA 562K 50	C37, C38
	CQMA 124K 50	C33, C34
	CQMA 242J 50	C7, C8
	CQMA 822J 50	C9, C10
	CQMA 303J 50	C35, C36

RESISTORS

NOTE: When ordering resistors, convert the resistance value into code form, and then rewrite the part no. as before.

Mark	Part No.	Symbol & Description
★	ACT-021	VR1 Variable (BALANCE)
★	ACT-126	VR2 Variable (VOLUME)
★	ACT-127	VR3 Variable (BASS)
★	ACT-127	VR4 Variable (TREBLE)
Δ	ACN-070	R71, R72 Wire wound (0.22+0.22/2W)
	RD1/4PM□□□J	R1-R18, R23-R68, R80-R82, R89
	RS2PL271J	R19
	RD1/2PS□□□J	R20, R75-R78, R83, R84, R86, R87, R94-R96
Δ	RD1/4PMF□□□J	R69, R70, R73, R74, R79, R88, R90-R93

SEMICONDUCTORS

Mark	Part No.	Symbol & Description
★★	NJM4558DX	Q1
★★	2SA798	Q2, Q3
★★	2SC1775A	Q4, Q5
★★	2SC945A	Q6, Q7
★★	2SC1735-D*	Q8, Q9
	(2SC1735-E*)	
★★	2SA850-D*	Q10, Q11
	(2SA850-E*)	

*hfe of Q8-Q11 should have the same value.

Mark	Part No.	Symbol & Description
★★	2SD525P-O)*	Q12, Q13
	(2SD525P-Y*)	
★★	2SB595P-O*	Q14, Q15
	(2SB595P-Y*)	
★★	2SC1815-GR	Q16
	*hfe of Q12-Q15 should have the same value.	
Δ ★	10E2	D1, D2
	(SIB01-02)	
★	MZ-197	D4
	(WZ-197)	
★	MZ-157	D3, D5
	(WZ-157)	
Δ ★	GP-20D	D6-D9

SWITCHES

Mark	Part No.	Symbol & Description
★★	ASE-110	S1 Rotary slide switch (FUNCTION)
★★	ASG-285	S2 Push switch (TAPE/ADAPTOR, LOUDNESS)
★★	ASG-266	S3 Push switch (SPEAKERS)

OTHERS

Mark	Part No.	Symbol & Description
	VBZ30P080FMC	Screw 3x8
	AKB-077	Terminal (PHONES)
	AKB-078	Terminal (TAPE/ADAPTOR)
	AKB-079	Terminal (INPUT)
	AKE-047	Terminal (SPEAKERS)
	AEC-078	Insulator wafer
	AKH-005	Insulator spacer
	ABA-257	Screw 2.5x16

Headphones Jack Assembly

Mark	Part No.	Symbol & Description
	AKN-030	Phones jack (PHONES)
	RD1/2PS331J	R86, R87

Fuse Assembly

Mark	Part No.	Symbol & Description
Δ	ACG-017	C100 Ceramic (0.01/AC125V)

9. PACKING

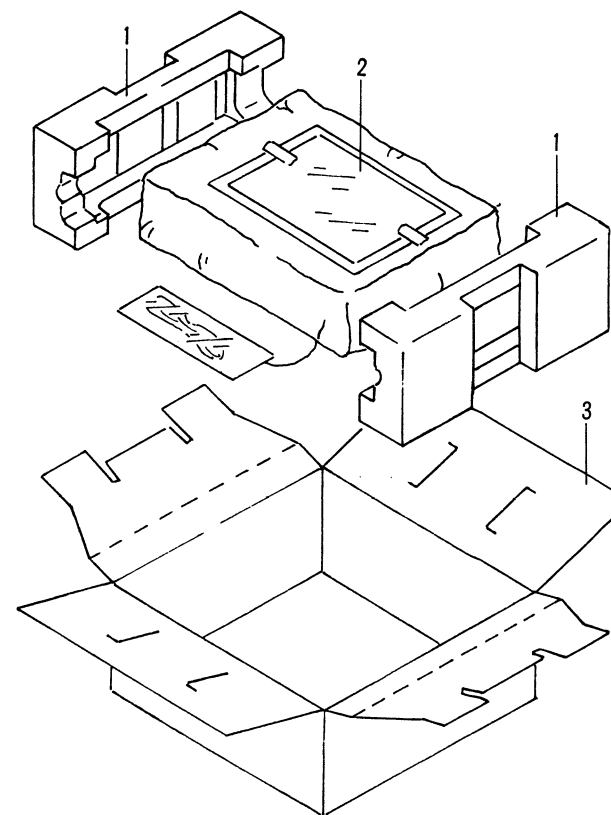

Mark	No.	Part No.	Description
	1.	AHA-290	Side pad
	2.	ARB-405	Operating instructions (English)
	3.	AHD-901	Packing case

10. ADJUSTMENT

Idle Current Adjustment

1. Turn the VOLUME control down to minimum level, turn the power on, and wait about 10 minutes.
2. Connect a DC voltmeter to the TP terminals (R ch; TP1 \ominus and TP2 \oplus , L ch; TP4 \ominus and TP3 \oplus) of the AF assembly.
3. Check that the voltage between TP1 and TP2 (R ch) lies within the DC 2mV–110mV range. Then make a similar check for the L ch (between TP3 and TP4). If the voltage is less than 2mV, cut jumper A (L ch), and jumper B (R ch). If the voltage exceeds 110mV, check for circuit failure.

- Remove the top cover

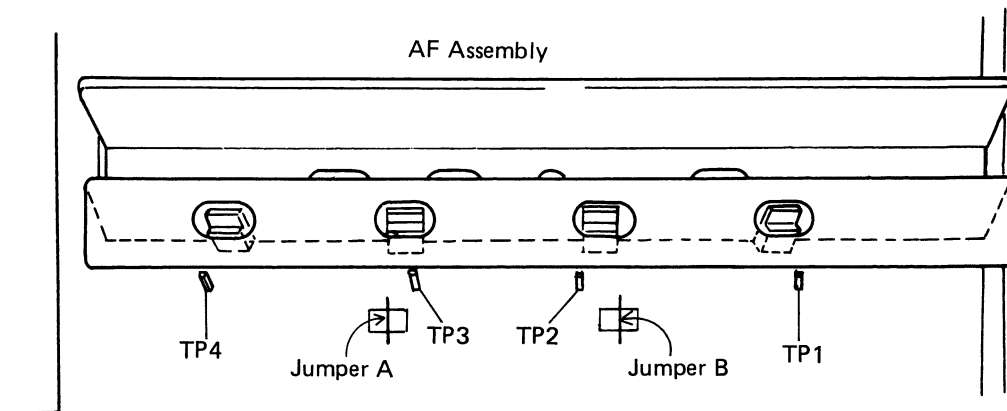

10. RÉGLAGE

Réglage du courant déwatté

1. Tourner la commande de volume sur la position minimum, mettre l'appareil sous tension et attendre environ 10 minutes.
2. Connecter un voltmètre CC aux bornes TP (voie droite: TP1 ⊖ et TP2 ⊕, voie gauche: TP4 ⊖ et TP3 ⊕) d'ensemble AF.
3. Vérifier que la tension entre TP1 et TP2 (voie droite) soit entre 2 mV et 110 mV CC. Vérifier de la même manière la voie gauche (entre TP3 et TP4). Couper l'interconnexion A (voie gauche) et l'interconnexion B (voie droite) si la tension est inférieure a 2 mV. Lorsque la tension est supérieure a 110 mV, s'assurer de l'absence de panne de circuit.

Enlever le couvercle

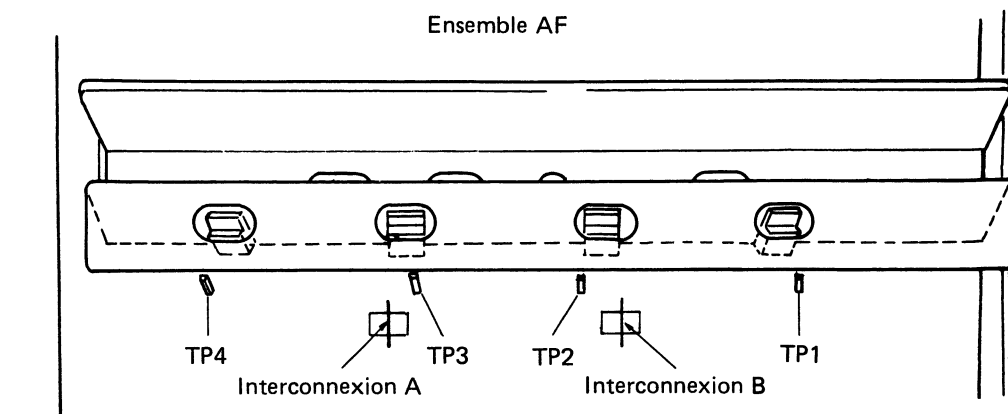

10. AJUSTE

Ajuste de la corriente devatiada

1. Poner el control de volumen (VOLUME) en su posición de nivel mínimo, conectar la alimentación y esperar unos 10 minutos.
2. Conectar un voltímetro de CC a los terminales TP (canal Der.; TP1 \ominus y TP2 \oplus , canal Izq.; TP4 \ominus y TP3 \oplus) del conjunto A.F.
3. Comprobar que la tensión entre TP1 y TP2 (canal Der.) esté dentro del margen de 2 mV - 110 mV CC. Luego realizar una comprobación similar para el canal Izq. (entre TP3 y TP4). Si la tensión es menor de 2 mV, cortar la conexión provisional A (canal Izq.), y conectar provisionalmente B (canal Der.). Si la tensión excede de 110 mV, comprobar que no haya ninguna avería en el circuito.

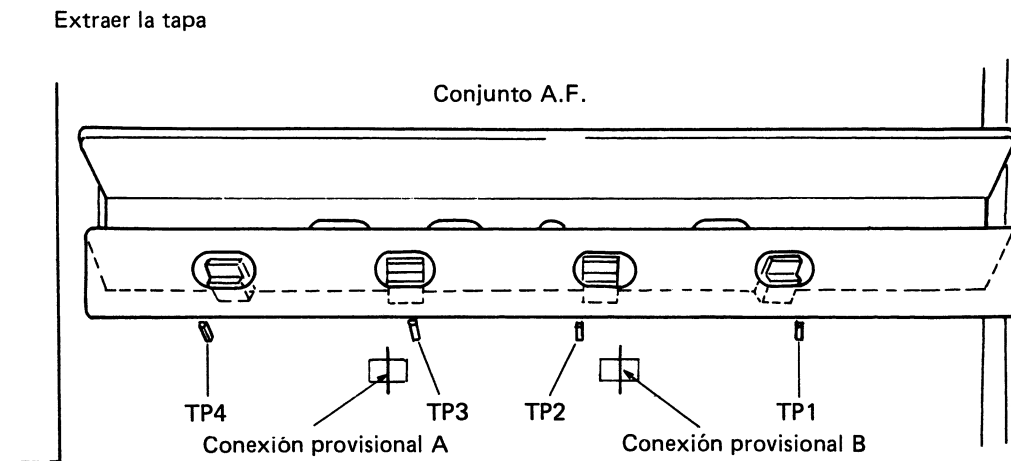

SCHEMATIC DIAGRAMS

For YP Type

NOTE:
The indicated semiconductors are representative ones only. Other alternative semiconductors may be used and are listed in the parts list.

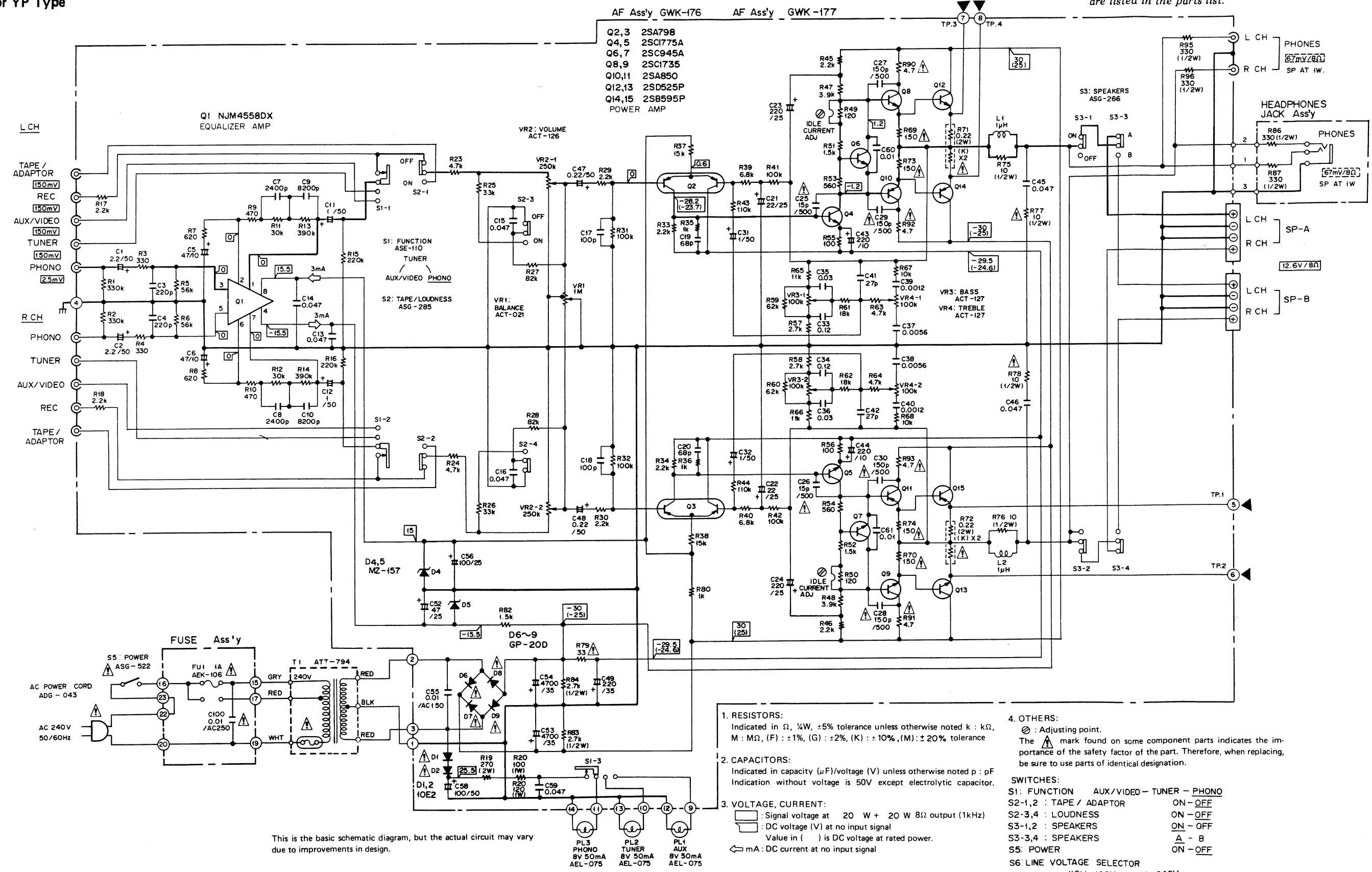

This is the basic schematic diagram, but the actual circuit may vary due to improvements in design.

For S Type

2

3

4

5

6

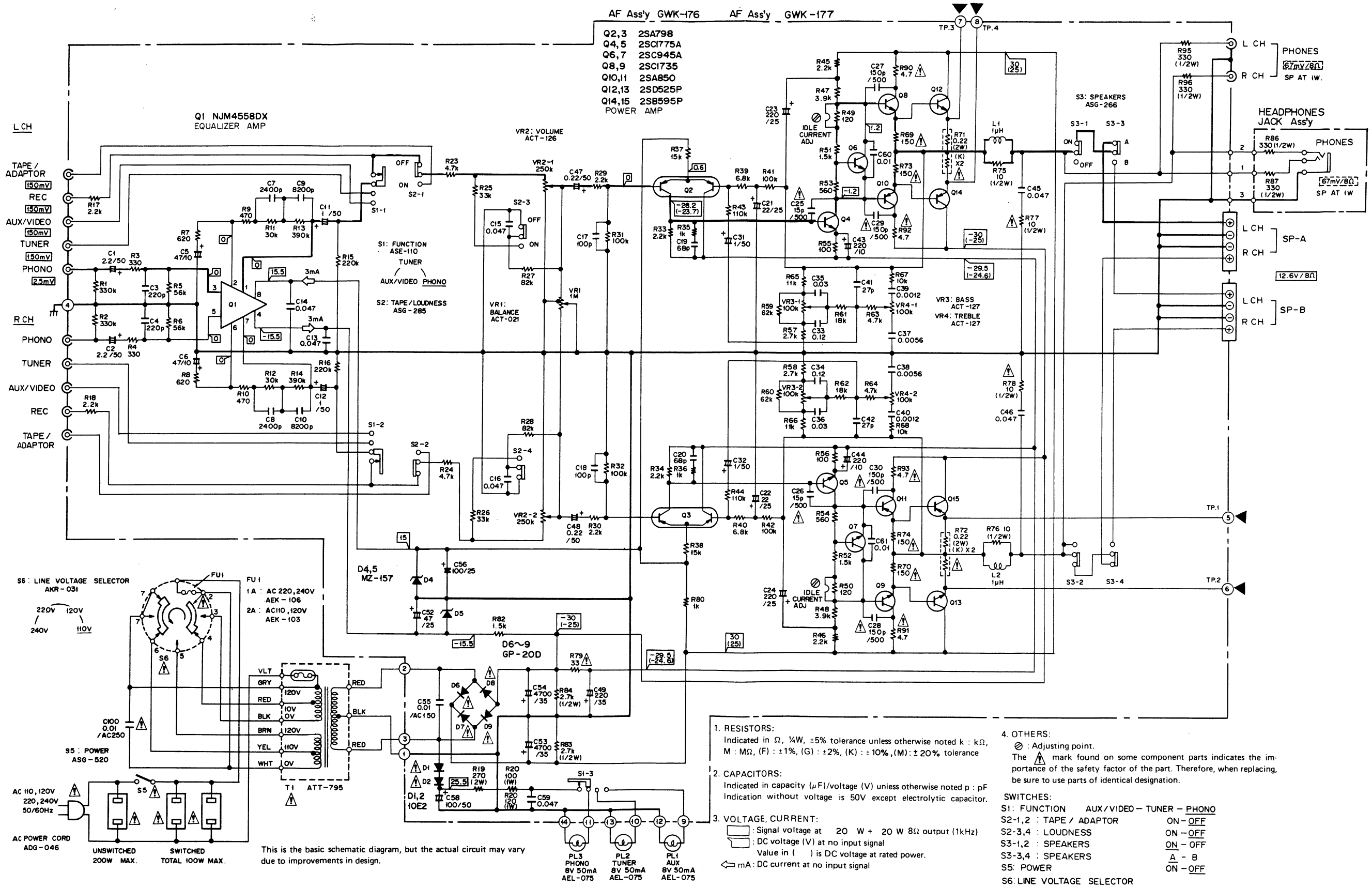

AF Ass'y GWK-176 AF Ass'y GWK-177

Q2,3 2SA798
Q4,5 2SC1775A
Q6,7 2SC945A
Q8,9 2SC1735
Q10,11 2SA850
Q12,13 2SD525P
Q14,15 2SB595P
POWER AMP

Q1 NJM4558DX
EQUALIZER AMP

VR2: VOLUME
ACT-126

S1: FUNCTION
ASE-110
TUNER

AUX/VIDEO PHONO

S2: TAPE/LOUDNESS
ASG-285

VR1: BALANCE
ACT-021

VR2-1 250k
VR2-2 250k

VR3: BASS
ACT-127

VR4: TREBLE
ACT-127

- RESISTORS:**
Indicated in Ω , $\frac{1}{4}W$, $\pm 5\%$ tolerance unless otherwise noted k : k Ω , M : M Ω , (F) : $\pm 1\%$, (G) : $\pm 2\%$, (K) : $\pm 10\%$, (M) : $\pm 20\%$ tolerance
- CAPACITORS:**
Indicated in capacity (μF)/voltage (V) unless otherwise noted p : pF
Indication without voltage is 50V except electrolytic capacitor.
- VOLTAGE, CURRENT:**
⊖ : Signal voltage at 20 W + 20 W 8 Ω output (1kHz)
⊖ : DC voltage (V) at no input signal
Value in () is DC voltage at rated power.
⊖ mA : DC current at no input signal
- OTHERS:**
⊕ : Adjusting point.
The Δ mark found on some component parts indicates the importance of the safety factor of the part. Therefore, when replacing, be sure to use parts of identical designation.

- SWITCHES:**
- | | |
|--------------|---------------------------|
| S1: FUNCTION | AUX/VIDEO - TUNER - PHONO |
| S2-1,2 | : TAPE / ADAPTOR |
| S2-3,4 | : LOUDNESS |
| S3-1,2 | : SPEAKERS |
| S3-3,4 | : SPEAKERS |
| S5: POWER | |

S6: LINE VOLTAGE SELECTOR
110V-120V - 220V - 240V
The underlined indicates the switch position.

This is the basic schematic diagram, but the actual circuit may vary due to improvements in design.

UNSWITCHED 200W MAX.
SWITCHED TOTAL 100W MAX.

1

2

3

4

5

6

Parts List of AF Assembly (GWK-176 for YP type, GWK-177 for S type)

CAPACITORS

Mark	Part No.	Symbol & Description	Mark	Part No.	Symbol & Description
⚠	CEANL 2R2M 50	C1, C2	★★	2SC945A	Q6, Q7
	ACH-217	C53, C54 Electrolytic (4700/35V)	★★	2SC1735-D*	Q8, Q9
	ACG-019	C55 Ceramic (0.01/AC150V)		(2SC1735-E*)	
	CEANL R22M 50	C47, C48	★★	2SA850-D*	Q10, Q11
	CEANL 010M 50	C31, C32		(2SA850-E*)	
				*hfe of Q8-Q11 should have the same value.	
	CEA 010M 50L	C11, C12			
	CEA 220M 25L	C21, C22	★★	2SD525P-O*	Q12, Q13
	CEA 470M 10L	C5, C6		(2SD525P-Y*)	
	CEA 101M 25L	C56	★★	2SB595P-O*	Q14, Q15
CEA 101 M 50L	C58		(2SB595P-Y*)		
			*hfe of Q12-Q15 should have the same value.		
	CEA 221M 10L	C43, C44			
	CEA 470M 25L	C52			
	CEA 221M 25L	C23, C24	⚠ ★	10E2	D1, D2
	CEA 221M 35L	C49		(SIB01-02)	
	CQMA 122K 50	C39, C40	★	MZ-157	D4, D5
				(WZ-157)	
	CQMA 562K 50	C37, C38	⚠ ★	GP-20D	D6-D9
	CQMA 124K 50	C33, C34			
	CQMA 242J 50	C7, C8			
	CQMA 822J 50	C9, C10			
	CQMA 303J 50	C35, C36			
⚠	CCDSL 150K 500	C25, C26			
	CCDSL 151K 500	C27-C30			
	CCDSL 270J 50	C41, C42			
	CCDSL 680J 50	C19, C20			
	CCDSL 101J 50	C17, C18			
	CCDSL 221J 50	C3, C4			
	CKDYF 473Z 50	C13-C16, C45, C46, C59			
	CKDYF 103Z 50	C60, C61			

SWITCHES

Mark	Part No.	Symbol & Description
★★	ASE-110	S1 Rotary slide switch (FUNCTION)
★★	ASG-285	S2 Push switch (TAPE/ADAPTOR, LOUDNESS)
★★	ASG-266	S3 Push switch (SPEAKERS)

OTHERS

Mark	Part No.	Symbol & Description
	VBZ30P080FMC	Screw 3x8
	AKB-077	Terminal (PHONES)
	AKB-078	Terminal (TAPE/ADAPTOR)
	AKB-079	Terminal (INPUT)
	AKE-047	Terminal (SPEAKERS)
	AEC-078	Insulator wafer
	AKH-005	Insulator spacer
	ABA-257	Screw 2.5x16

RESISTORS

NOTE: When ordering resistors, convert the resistance value into code form, and then rewrite the part no. as before.

Mark	Part No.	Symbol & Description
★	ACT-021	VR1 Variable (BALANCE)
★	ACT-126	VR2 Variable (VOLUME)
★	ACT-127	VR3 Variable (BASS)
★	ACT-127	VR4 Variable (TREBLE)
⚠	ACN-070	R71, R72 Wire wound (0.22+0.22/2W)
	RD1/4PM□□□J	R1-R18, R23-R68, R80, R82
	RS2PL271J	R19
	RD1/2PS□□□J	R75, R76, R83, R84, R95, R96
⚠	RD1/4PMFL□□□J	R69, R70, R73, R74, R79, R90-R93
	RS1PL□□□J	R20
	RD1/2PSF100J	R77, R78

Parts List of Fuse Assembly (for YP Type)

Mark	Part No.	Symbol & Description
⚠	ACG-001	C100 Electrolytic (0.01/AC250V)

SEMICONDUCTORS

Mark	Part No.	Symbol & Description
★★	NJM4558DX	Q1
★★	2SA798	Q2, Q3
★★	2SC1775A (2SC1915)	Q4, Q5

CONTRAST OF MISCELLANEOUS PARTS

NOTES:

- Parts without part number cannot be supplied.
- The Δ mark found on some component parts indicates the importance of the safety factor of the part. Therefore, when replacing, be sure to use parts of identical designation.
- For your Parts Stock Control, the fast moving items are indicated with the marks **★★** and **★**.
★★ GENERALLY MOVES FASTER THAN ★.
 This classification shall be adjusted by each distributor because it depends on model number, temperature, humidity, etc.

P.C. BOARD ASSEMBLY

Mark	Symbol & Description	Part No.			Remarks
		KU type	YP type	S type	
	AF assembly	GWK-174	GWK-176	GWK-177	

ELECTRICAL PARTS

Mark	Symbol & Description	Part No.			Remarks
		KU type	YP type	S type	
Δ ★	T1 Power transformer (120V)	ATT-793	
Δ ★	T1 Power transformer (240V)	ATT-794	
Δ ★	T1 Power transformer (110V, 120V, 220V, 240V)	ATT-795	
Δ ★★	FU1 Fuse (2.5A)	AEK-102	
Δ ★★	FU1 Fuse (1A)	AEK-106	AEK-106	
Δ ★★	S1 Push switch (POWER)	ASG-521	ASG-522	ASG-520	
Δ ★★	S2 Line voltage selector	AKR-031	
Δ	C1 Ceramic capacitor (0.01/AC 250V)	ACG-001	
Δ	AC socket (AC OUTLETS)	AKP-041	AKP-041	
Δ	AC power cord	ADG-052	ADG-043	ADG-046	
	Screw 3 x 8 (for line voltage selector)	BMZ30P080FZK	

PACKING AND FURNISHED PARTS

Mark	Symbol & Description	Part No.			Remarks
		KU type	YP type	S type	
Δ ★★	Fuse (1A)	AEK-106	
Δ ★★	Fuse (2A)	AEK-103	
	Operating instructions (English)	ARB-405	ARB-406	ARB-406	
	Packing case	AHD-901	AHD-902	AHD-902	

ADDITIONAL

 **PIONEER®**

Service Manual

STEREO AMPLIFIER

SA-420 YP, S

This additional service manual is applicable to the YP type (Australia model), S type (General export model). The basic performance of the YP and S types is the same as the KU type (U.S.A. model), please refer to the KU type service manual (pp. 1 – 17) with the exception of this supplements.

SPECIFICATIONS

The specifications for YP and S types are the same as the KU type except for following sections:

Miscellaneous

Power Requirements

YP type AC 240V, 50/60HZ

S type AC 110/120/220/240V (Switchable), 50/60Hz

Power Consumption

YP type 150W

S type 60W

ADDITIONAL

PIONEER®

Service Manual

ORDER NO.
ART-647-0

STEREO AMPLIFIER

SA-420

HE, HB

SA-204 HE

- Both Model SA-420 and SA-204 have the same basic performance, but there are a few minor changes in design.
- The basic performance of the HE and HB types is the same as the KU type, please refer to the KU type service manual (ART-646) with the exception of this supplements.

SPECIFICATIONS

The specifications for HE and HB types are the same as the KU type except for following sections:

Amplifier Section

Hum and Noise (DIN, continuous Power/50mW)
 PHONO. 67dB/62dB
 TUNER, AUX, TAPE PLAY 85dB/62dB

Miscellaneous

Power Requirements AC 220V/240V (Switchable)
 50/60Hz
 Power Consumption 150W

Line Voltage Section

Line voltage can be changed with following steps.

1. Disconnect the AC power cord.
2. Remove the Top cover.
3. Take out the fuse (AEK-406) from the fuse assembly.
4. Re-install the fuse in the correct voltage indication (see Fig. 1).
5. Stick the line voltage label on the rear panel.

Part No.	Description
AAX-193	220V label
AAX-192	240V label

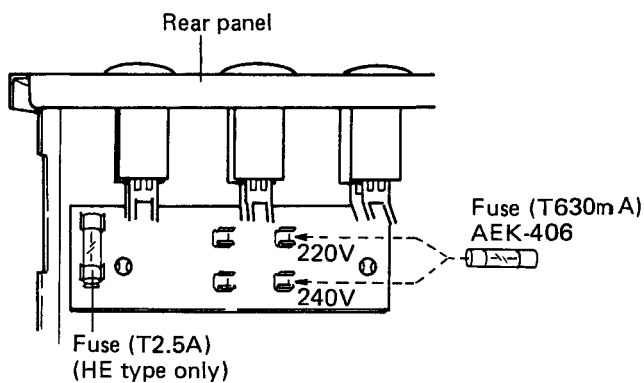

Fig. 1

PIONEER ELECTRONIC CORPORATION 4-1, Meguro 1-Chome, Meguro-ku, Tokyo 153, Japan
 U.S. PIONEER ELECTRONICS CORPORATION 85 Oxford Drive, Moonachie, New Jersey 07074, U.S.A.
 PIONEER ELECTRONIC (EUROPE) N.V. Luithagen-Haven 9, 2030 Antwerp, Belgium
 PIONEER ELECTRONICS AUSTRALIA PTY. LTD. 178-184 Boundary Road, Braeside, Victoria 3195, Australia

Y L © MAY 1981

Printed in Japan

CONTRAST OF MISCELLANEOUS PARTS

NOTES:

- Parts without part number cannot be supplied.
- The \triangle mark found on some component parts indicates the importance of the safety factor of the part. Therefore, when replacing, be sure to use parts of identical designation.
- For your Parts Stock Control, the fast moving items are indicated with the marks **★★** and **★**.
★★ GENERALLY MOVES FASTER THAN ★.
This classification shall be adjusted by each distributor because it depends on model number, temperature, humidity, etc.

P.C. BOARD ASSEMBLY

Mark	Symbol & Description	Part No.			
		SA-420/KU	SA-420/HB	SA-420/HE	SA-204/HE
	AF assembly	GWK-174	GWK-175	GWK-175	GWK-175

ELECTRICAL PARTS

Mark	Symbol & Description	Part No.			
		SA-420/KU	SA-420/HB	SA-420/HE	SA-204/HE
\triangle ★	T1 Power transformer (120V)	ATT-793
\triangle ★	T1 Power transformer (220V/240V)	ATT-794	ATT-794	ATT-794
\triangle ★★	FU1 Fuse (2.5A)	AEK-102
\triangle ★★	FU1 Fuse (T630mA/250V)	AEK-406	AEK-406	AEK-406
\triangle ★★	FU2, FU3 Fuse (T2A/250V)	AEK-017	AEK-017	AEK-017
\triangle ★★	FU4 Fuse (T2.5A/250V)	AEK-403	AEK-403
\triangle ★★	S1 Push switch (POWER)	ASG-521	ASG-522	ASG-522	ASG-522
\triangle	AC socket (AC OUTLETS)	AKP-041	AKP-044	AKP-026	AKP-026
\triangle	AC power cord	ADG-052	ADG-051	ADG-041	ADG-041

OTHERS

Mark	Symbol & Description	Part No.			
		SA-420/KU	SA-420/HB	SA-420/HE	SA-204/HE
	Front panel assembly	ANM-008	ANM-008	ANM-008	ANM-043
	Knob (VOLUME, FUNCTION)	AAB-251	AAB-251	AAB-251	AAB-276
	Knob (BASS, TREBLE, BALANCE)	AAB-250	AAB-250	AAB-250	AAB-275

PACKING AND FURNISHED PARTS

Mark	Symbol & Description	Part No.			
		SA-420/KU	SA-420/HB	SA-420/HE	SA-204/HE
	Operating instructions (English)	ARB-405	ARB-406
	Operating instructions (English/German/French/Italian)	ARD-160
	Operating instructions (French)	ARD-173
	Packing case	AHD-901	AHD-902	AHD-902	AHD-935

SCHEMATIC DIAGRAM

NOTE:
The indicated semiconductors are representative ones only. Other alternative semiconductors may be used and are listed in the parts list.

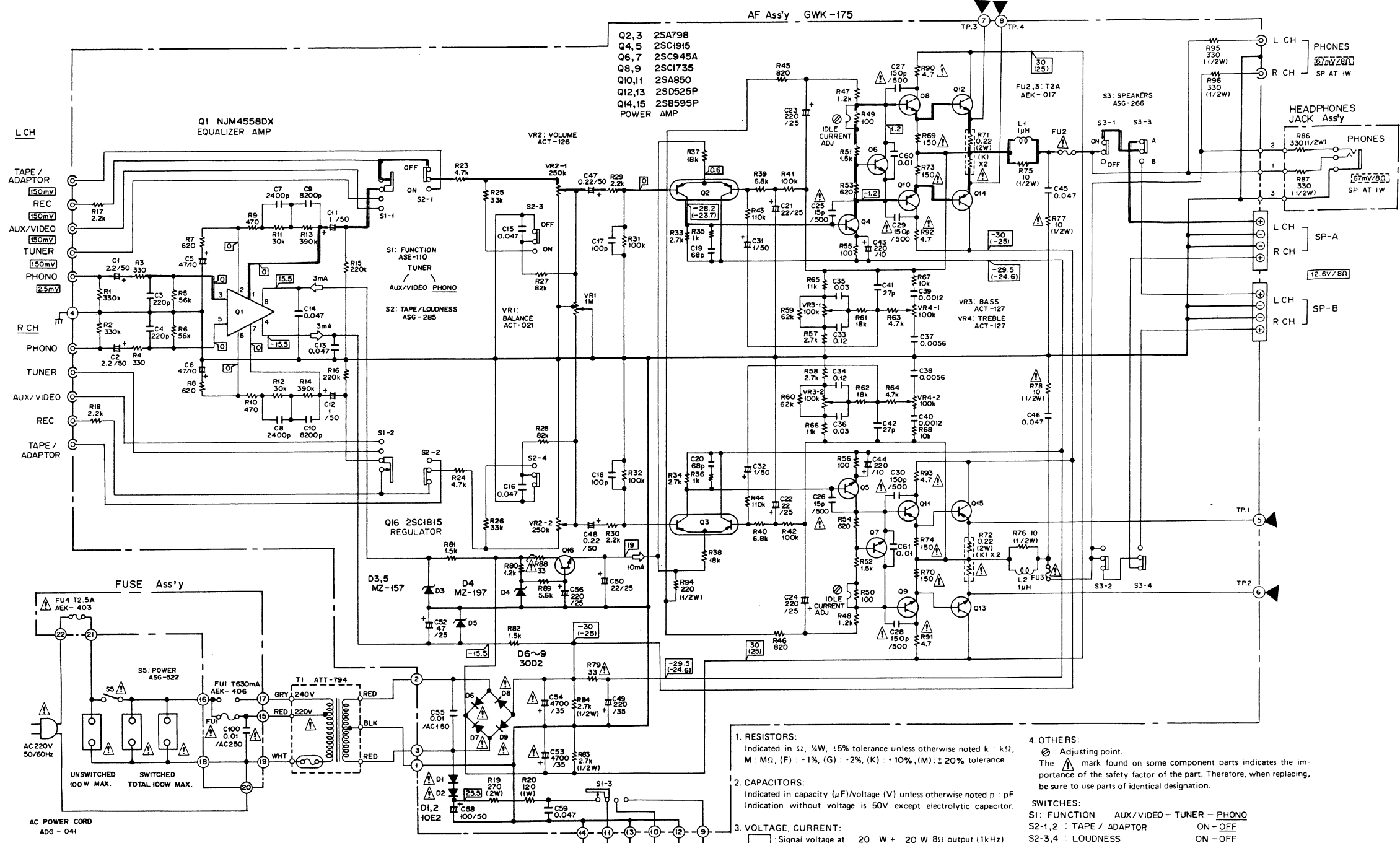

- Q2,3 2SA798
- Q4,5 2SC1915
- Q6,7 2SC945A
- Q8,9 2SC1735
- Q10,11 2SA850
- Q12,13 2SD525P
- Q14,15 2SB595P

1. RESISTORS:
Indicated in Ω, ¼W, ±5% tolerance unless otherwise noted k : kΩ, M : MΩ, (F) : ±1%, (G) : ±2%, (K) : ±10%, (M) : ±20% tolerance
2. CAPACITORS:
Indicated in capacity (μF)/voltage (V) unless otherwise noted p : pF
Indication without voltage is 50V except electrolytic capacitor.
3. VOLTAGE, CURRENT:
□ Signal voltage at 20 W + 20 W 8Ω output (1kHz)
□ DC voltage (V) at no input signal
Value in () is DC voltage at rated power.
◀ mA : DC current at no input signal
4. OTHERS:
⊗ : Adjusting point.
The Δ mark found on some component parts indicates the importance of the safety factor of the part. Therefore, when replacing, be sure to use parts of identical designation.

- SWITCHES:
- S1 : FUNCTION AUX / VIDEO - TUNER - PHONO
 - S2-1, 2 : TAPE / ADAPTOR ON - OFF
 - S2-3, 4 : LOUDNESS ON - OFF
 - S3-1, 2 : SPEAKERS ON - OFF
 - S3-3, 4 : SPEAKERS A - B
 - S5 : POWER ON - OFF
- The underlined indicates the switch position.

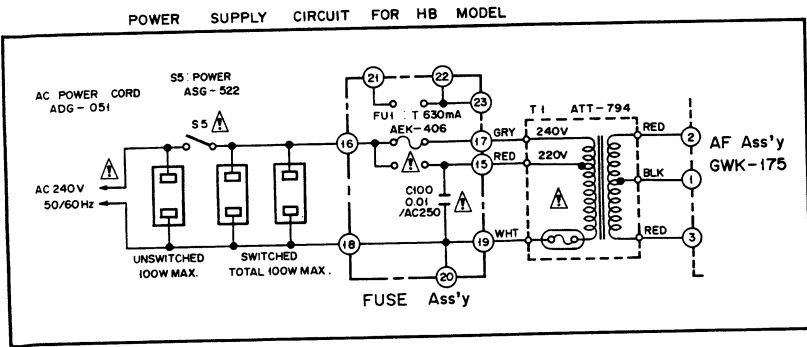

This is the basic schematic diagram, but the actual circuit may vary due to improvements in design.

P.C. BOARD ASSEMBLIES

AF Assembly (GWK-175)

Fuse Assembly

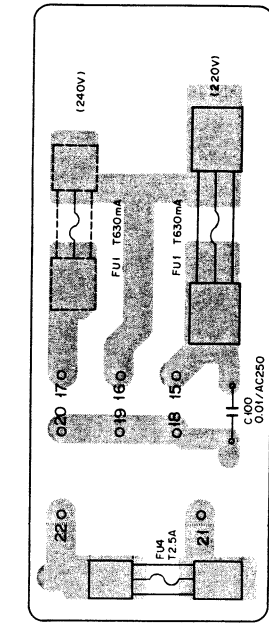
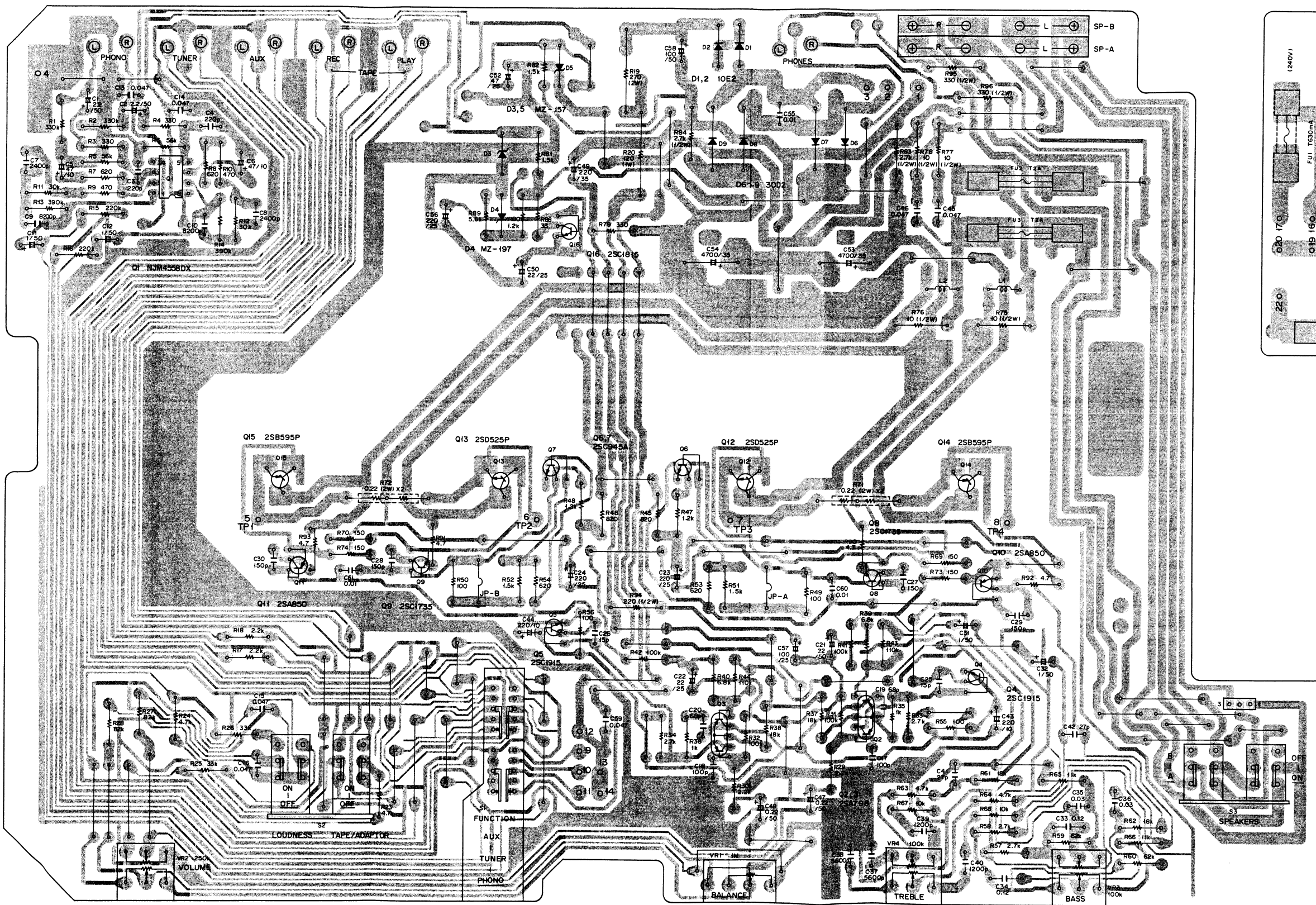

A

A

B

B

C

C

D

D

Parts List of AF Assembly (GWK-175)

CAPACITORS

Mark	Part No.	Symbol & Description
△	CEANL 2R2M 50	C1, C2
	ACH-217	C53, C54 Electrolytic (4700/35V)
	ACG-019	C55 Ceramic (0.01/AC150V)
	CEANL 2R2M 50	C47, C48
	CEANL 010M 50	C31, C32
	CEA 010M 50L	C11, C12
	CEA 220M 25L	C21, C22, C50
	CEA 470M 10L	C5, C6
	CEA 101M 25L	C57
	CEA 101M 50L	C58
	CEA 221M 10L	C43, C44
	CEA 470M 25L	C52
CEA 221M 25L	C23, C24, C56	
CEA 221M 35L	C49	
CQMA 122K 50	C39, C40	
CQMA 562K 50	C37, C38	
CQMA 124K 50	C33, C34	
CQMA 242J 50	C7, C8	
CQMA 822J 50	C9, C10	
CQMA 303J 50	C35, C36	
△	CCDSL 150K 500	C25, C26
	CCDSL 151K 500	C27—C30
△	CCDSL 270J 50	C41, C42
	CCDSL 680J 50	C19, C20
	CCDSL 101J 50	C17, C18
	CCDSL 221J 50	C3, C4
	CKDYF 473Z 50	C13—C16, C45, C46, C59
CKDYF 103Z 50	C60, C61	

SEMICONDUCTORS

Mark	Part No.	Symbol & Description
★★	NJM4558DX	Q1
★★	2SA798	Q2, Q3
★★	2SC1915	Q4, Q5
★★	2SC945A	Q6, Q7
★★	2SC1735-D* (2SC1735-E*)	Q8, Q9
★★	2SA850-D* (2SA850-E*)	Q10, Q11
*hfe of Q8—Q11 should have the same value.		
★★	2SD525P-O* (2SD525P-Y*)	Q12, Q13
★★	2SB595P-O* (2SB595P-Y*)	Q14, Q15
★★	2SC1815-GR	Q16
*hfe of Q12—Q15 should have the same value.		
△	★ 10E2 (SIB01-02)	D1, D2
	★ MZ-157 (WZ-157)	D3, D5
	MZ-197 (WZ-197)	D4
△	★ 30D2	D6—D9

SWITCHES

Mark	Part No.	Symbol & Description
★★	ASE-110	S1 Rotary slide switch (FUNCTION)
★★	ASG-285	S2 Push switch (TAPE/ADAPTOR, LOUDNESS)
★★	ASG-266	S3 Push switch (SPEAKERS)

RESISTORS

Note: When ordering resistors, convert the resistance value into code form, and then rewrite the part no. as before.

Mark	Part No.	Symbol & Description
★	ACT-021	VR1 Variable (BALANCE)
★	ACT-126	VR2 Variable (VOLUME)
★	ACT-127	VR3 Variable (BASS)
★	ACT-127	VR4 Variable (TREBLE)
△	ACN-070	R71, R72 Wire wound (0.22 + 0.22/2W)
	RD½PM□□□J	R1—R18, R23—R68, R80—R82, R89
	RS2PL271J	R19
	RD½PS□□□J	R75, R76, R83, R84, R94—R96
△	RD½PMFL□□□J	R69, R70, R73, R74, R79, R88, R90—R93
	RS1PL121J	R20
	RD½PSF100J	R77, R78

OTHERS

Mark	Part No.	Symbol & Description
	VBZ30P080FMC	Screw 3x8
	AKB-077	Terminal (PHONES)
	AKB-078	Terminal (TAPE/ADAPTOR)
	AKB-079	Terminal (INPUT)
	AKE-047	Terminal (SPEAKERS)
	AEC-078	Insulator wafer
	AKH-005	Insulator spacer
	ABA-257	Screw 2.5x16

Parts List of Fuse Assembly

Mark	Part No.	Symbol & Description
△	ACG-001	C100 Electrolytic (0.01/AC250V)